

# 22" Widescreen Flat Panel Industrial Displays

## FEATURES

- **Industrial Grade** for demanding environments.
- **Precision-milled, Heavy-duty Bezels** ensure longer display life.
- **Polycarbonate Viewing Windows** are bulletproof and scratch-resistant.
- **Longlife Backlights** ensure trouble-free operation.
- **Multiple Touchscreen Options** for different applications and environments.
- **Easy upgrade of CRT to Flat Panel** without any cabinet modification.
- **Powder-coated 3/8" Thick Aluminum Bezels** are extremely durable and maintain appearance.
- **Polished Stainless Steel Bezels** are precision-milled from 3/16" plate.
- **Custom Colors and Private Labeling** for OEM manufacturers.
- **Available from Stock** in every configuration.
- **3 Year Warranty** on displays and electronics



### Industrial Strength

STRONGARM's Flat Panel Displays are designed to survive the most demanding industrial applications. Because the display elements are built into precision-milled, solid aluminum or stainless steel bezels, they remain secure and free from stress. The possibility of life-shortening display deformation is significantly reduced when installed in a panel cut-out.

### Current Technology

Unlike most other display offerings, STRONGARM displays are updated to the current technology immediately. You can be sure that the STRONGARM display you purchase today is not yesterday's trailing edge.

# 22" Widescreen Flat Panel Industrial Displays

## Touchscreen Specifications

### Resistive Touchscreen *(for 90% of all touchscreen applications)*

The Resistive Touchscreen uses a glass panel overlay with a uniform resistive coating. A polyester coversheet is tightly suspended over the top of the glass, separated by small, transparent insulating dots. The coversheet has a hard durable coating on the outer side and a conductive coating on the inner side. When the screen is touched, the conductive coating makes electrical contact with the coating on the glass. The voltages produced are the analog representation of the position touched. The controller digitizes these voltages and transmits them to the computer for processing.

|                        |  |
|------------------------|--|
| Touch Activation Force | Less than 4 ounces, typical                    |
| Accuracy               | 0.080 inches, typical<br>0.180 inches, minimum |
| Touchpoint Density     | 4096 x 4096 or > 100,000 touchpoints/inch      |
| Temperature            | Exceeds display rating                         |

# 22" Widescreen Flat Panel Industrial Displays

## Cut-out Dimensions

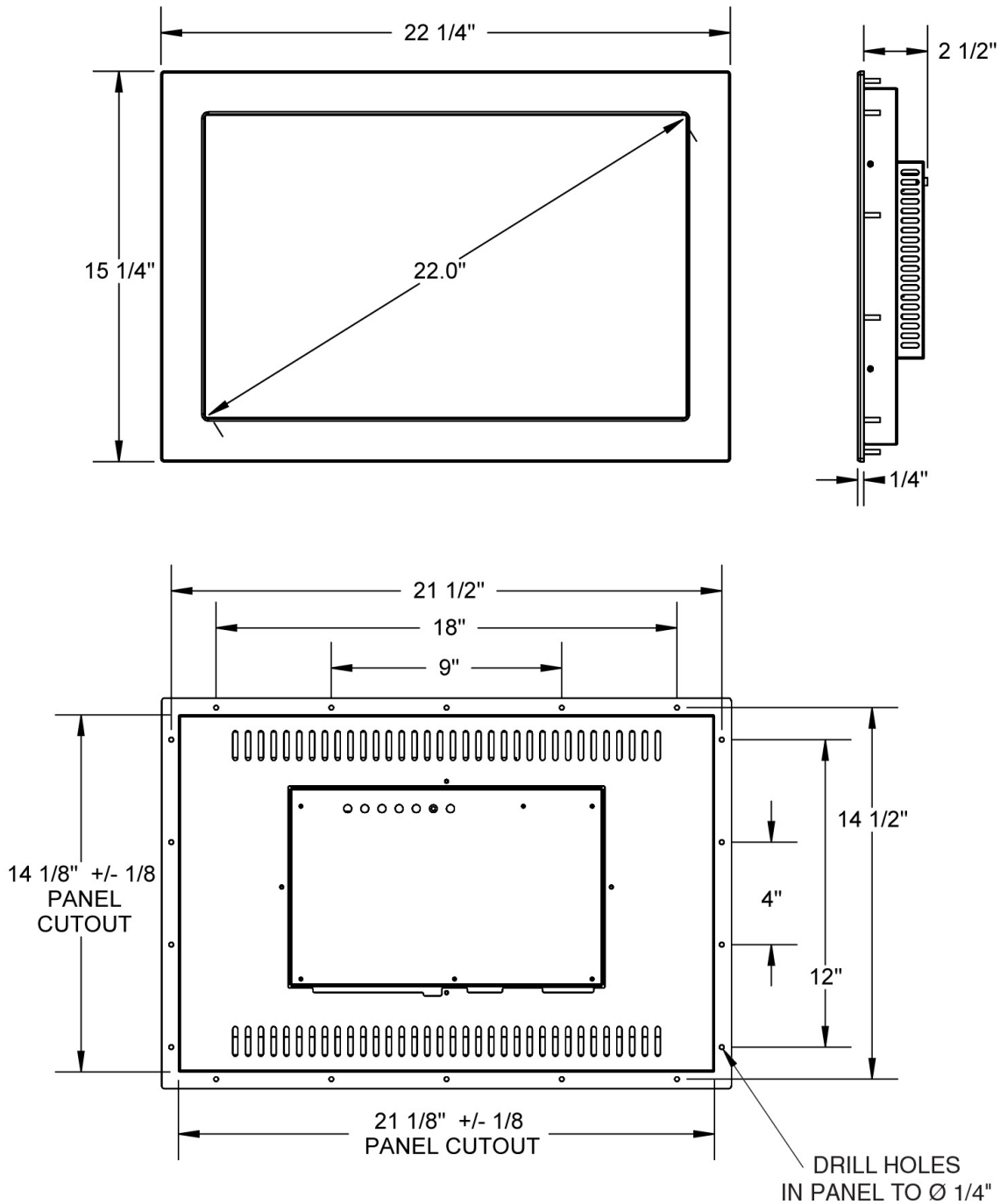

# 22" Widescreen Flat Panel Industrial Displays

## Specifications

### Display

|                 |             |
|-----------------|-------------|
| Size:           | 22"         |
| Brightness:     | 250 nits    |
| Contrast Ratio: | 1000:1      |
| Resolution:     | 1680 x 1050 |
| Colors:         | 16.7 M      |

### Power

|             |                     |
|-------------|---------------------|
| Consumption | 55W                 |
| Input       | AC 90-264V~ 50/60Hz |

### Environmental

#### Operating Conditions

|             |                              |
|-------------|------------------------------|
| Temperature | 32°F to 122°F (0°C to 50 °C) |
| Humidity    | 20 % to 95 % non-Condensing  |

#### Storage Conditions

|             |                               |
|-------------|-------------------------------|
| Temperature | -4°F to 140°F (-20°C to 60°C) |
| Humidity    | 5 % to 95 % non-Condensing    |

## Ordering Information

### NEMA Series

|     |           |
|-----|-----------|
| 304 | NEMA 4/12 |
| 404 | NEMA 4X   |



### Touchscreens

|   |           |
|---|-----------|
| 0 | None      |
| T | Resistive |